

TYPE 607

Pressure switch with changeover switch
With M12 plug insert

Width across flats 27
Height without connector 52mm
Thread length 9mm



	ADJUSTMENT RANGE [bar]	OVERPRESSURE SAFETY	ORDER NUMBER
DIAPHRAGM	0,2 – 2	100 bar	607-2-ABC
	1 – 10		607-10-ABC
	2 – 20	300 bar	607-20-ABC
	5 – 50		607-50-ABC
	10 – 100		607-100-ABC
PISTON	10 – 100	600 bar	607-100-ABC
	20 – 200		607-200-ABC

REPRODUCIBILITY	~ 2-5%	ELECTRICITY MAX.	6 Amp.
HYSTERESIS	~ 20% ; smaller upon request	TYPE OF PROTECTION	IP 65
SWITCHING ELEMENT	Changeover contact	PERMISSIBLE TEMP.	-20° to +80° C
SWITCHING FREQUENCY	200/min	WEIGHT	0,12 kg
VOLTAGE	250 Volt		

A Thread

	A
G 1/8	1
G 1/4	2
M 10X1 CYLINDRICAL	3
NPT 1/8	4
R 1/8 TAPERED	5
M 10X1 TAPERED	6
M 12	7
M 12X1,5	8
NPT 1/4	9

B Sealing element

	B	APPLICATION
DIAPHRAGM	NBR	1 Hydraulic oil, Machine oil, Heating oil, Nitrogen, sea water
	FKM (VITON)	2 Hydraulic fluids, Petrol, Alcohol, Salt and Sulphuric acid
	EPDM (APTK)	3 Hydrogen, Brake fluid, Acetylene, etc.
PISTON	SILICONE	4 Food, Water etc.
	PISTON SEALING	8 Oil
	PISTON SEALING	9 Hot water

C Body material

	C
STEEL GAL ZN 5	1
VA 1.4305	2
BRASS 60	3
VA 1.4571	8

D Customized version

	D
MICROSWITCH WITH GOLD PLATED CONTACTS	5
WATERPROOF MICROSWITCH WITH GOLD PLATED CONTACTS	6

The Open, Close or Change function refers to increasing pressure.

A Kant pressure switch Type 607 has an integrated electric change over switch. When pressure is applied, a diaphragm is deformed or a piston is displaced via a lifting movement. The deformation or movement depends on an adjustable spring preload. When the switching point is reached, the diaphragm or piston has undergone a defined movement which actuates the switch and opens or closes the electrical circuit. Specific pressure values can be monitored via the switching signal.

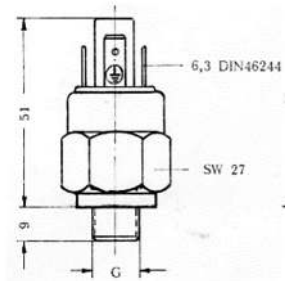

- Flat connector 6,3 DIN 46244
- With device connector 600 with M12 plug insert
- Plug connection 6x60° pivotable

CONNECTION:

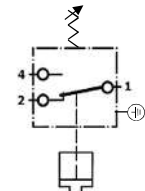

➔ Order Number Example:

ABC
607-XX-1285

- Customized version
- Material
- Sealing element
- Thread
- Setting range
- Type